

A

B

C

D

REVISIONS

ZONE

REV.

DESCRIPTION

DATE

APPD.

1

2

3

4

5

6

7

8

9

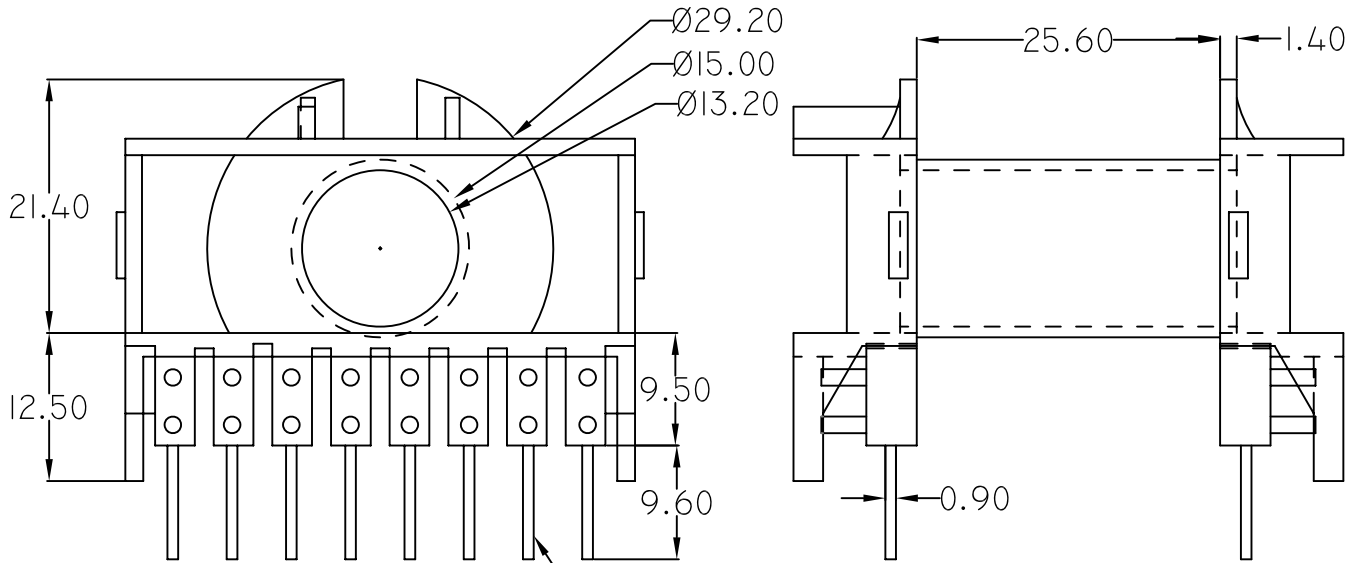

16PIN Ø0.9MM

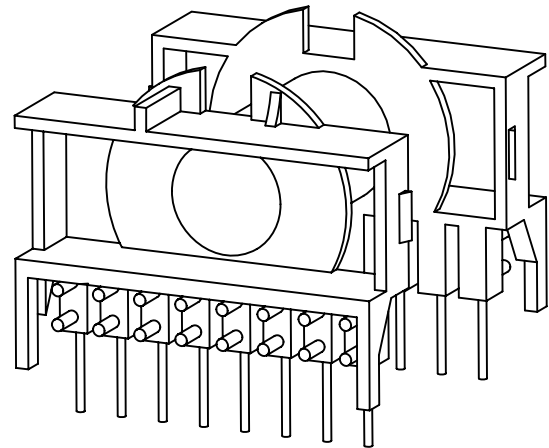
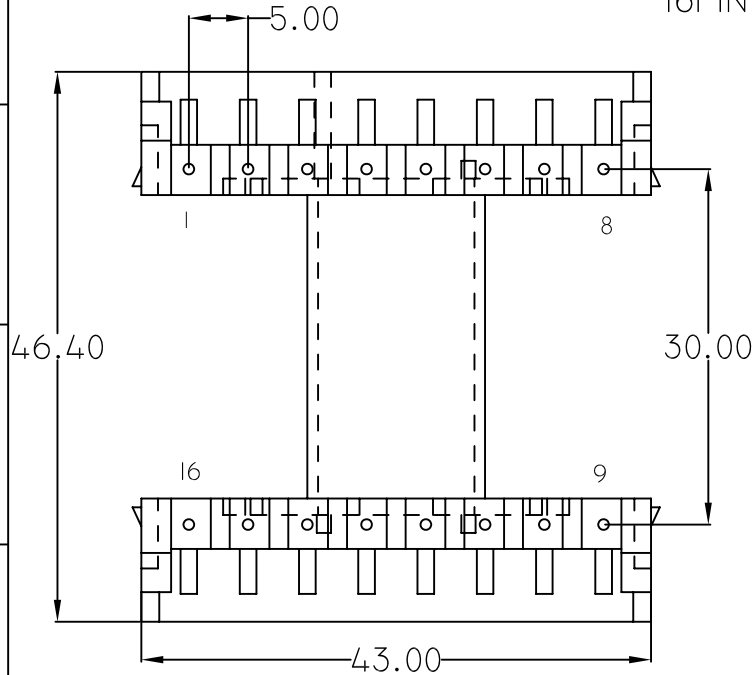

COMPONENT WEIGHT : 12.5 GMS

NOTE:

(1) All dimensions are in mm.
 (2) Tolerance for all dimension is ± 0.2

(3) Molding Material:

(a) Zytel FR 50 BK 153J - UL & RoHS
 (b) Zytel 70G33L BK 031 - Non UL
 (c) Zytel 70G33L NC 010 - Non UL
 (d) Rynite FR530L BK507 - UL & RoHS
 (e) Ultramid A3X2G5 - UL & RoHS
 (5) Pin Material: C.C.S Wire with Tin (Su) Plated



DURGA ELECTRONICS(INDIA)

COMPONENT NAME: BOBBIN

PART NO: ETD3913 HOR. 16PIN

REMARKS:

REV.
00

	NAME	SIGN.	DATE
DESIGN BY	SACHIDANAND	<i>Sachidanand</i>	13.12.02
CHECKED BY	MANOJ GUPTA		13.12.02
APPR. BY	MANOJ GUPTA		13.12.02

SCALE: NTS DRG. NO: DEI/DRG/0134

PATH
↓

D:\DURGA\ETD SERIES\ETD3913 HORIZONTAL 16PIN